

Caution

- Tie down long or wide loads at the front and rear of the vehicle with non-elastic straps. If it looks like it can catch some air, it will. TIE IT DOWN!
- When loading your surf gear or kayak, ensure that it is mounted correctly using the tie downs provided and is positioned centrally, parallel to the vehicle.
- Check straps periodically during travel and tighten if necessary. Replace any straps that are worn or frayed before using (see your Prorack dealer).

Important Warning

- It is critical that all Prorack racks and accessories be properly and securely attached to your vehicle. Improper attachment could result in an automobile accident, and could cause serious bodily injury or death to you or to others.
- You are responsible for securing the racks and accessories to your car, checking the attachments prior to use, and periodically inspecting the products for adjustment, wear, and damage. Therefore, you must read and understand all of the instructions and cautions supplied with your Prorack product prior to installation or use.
- If you do not understand all of the instructions and cautions, or if you have no mechanical experience and are not thoroughly familiar with the installation procedures, you should have the product installed by a professional installer such as a boat carrier specialist.

Kit Contents

Item	Component	Qty
1	M6 x 12 Buttonhead Capscrew	4
2	M6 x 20 Buttonhead Capscrew	4
3	Hoop Flat	1
4	38 mm U-bolt	4
5	M6 Nut Spring	4
6	M6 Hex Nut	1
7	3 Lobe Knob	8
8	Cambuckle	1
9	Upright Kayak Stand	2
10	M6 T-Slot Nut	4
11	Steel Crossbar	1
12	Strap Flat	1
13	38 mm U-bolt plate	4
14	Steel Endcap	2
15	Tie Down Strap	2
16	25 mm Solid Striped Webbing, 5 m	1
17	4 mm Allen Key	1

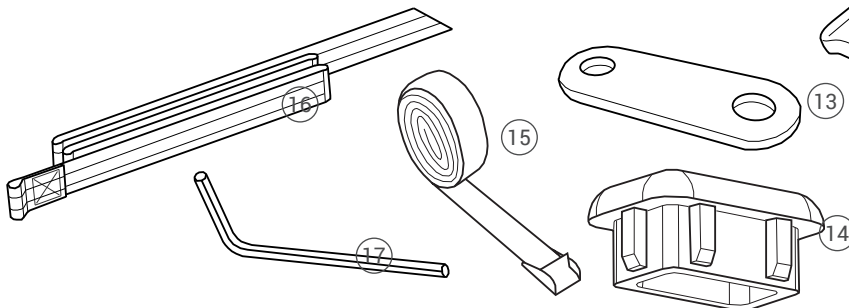
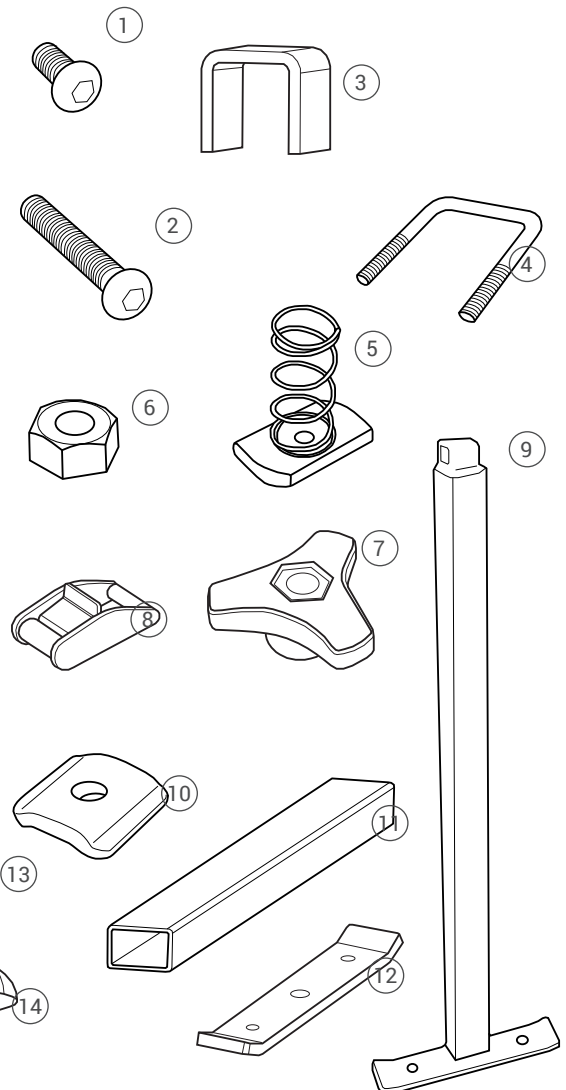

Installation for Flush and Through Bars

- 1** For Flush Bar, remove cover with keys.

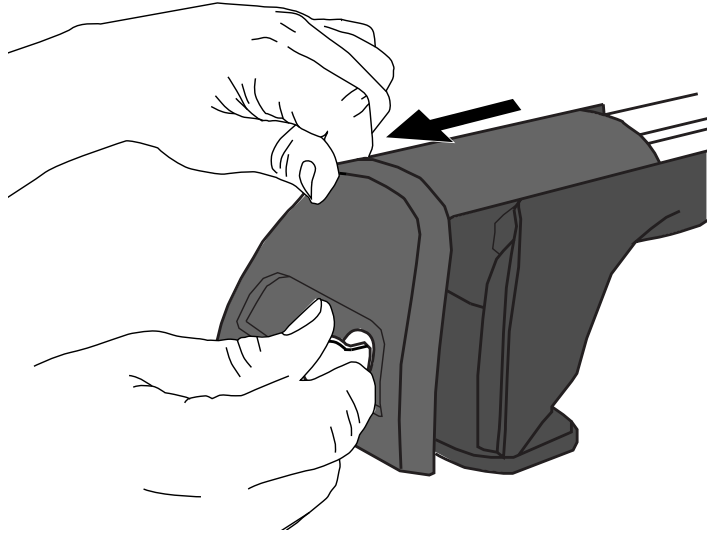

- 2** For Through Bars, unfasten security screw with an Allen Key and lift the accessory tab up.

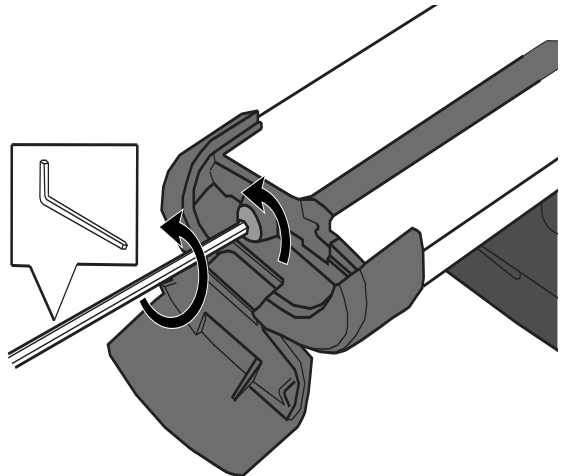

- 3** Push down rubber infill.

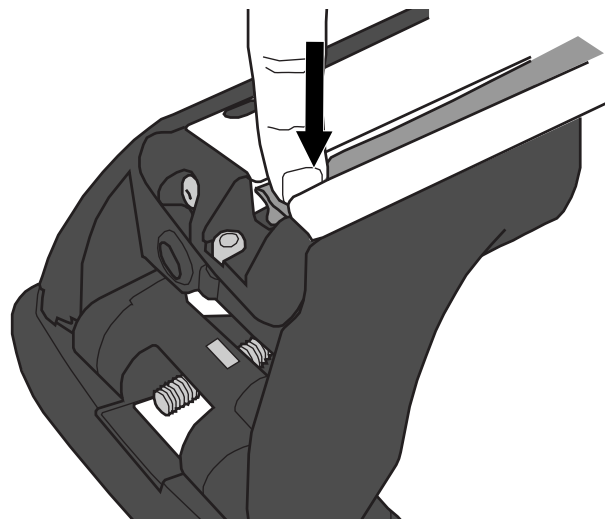

4

Slide square nut along channel.

Position where you want the accessory to be.

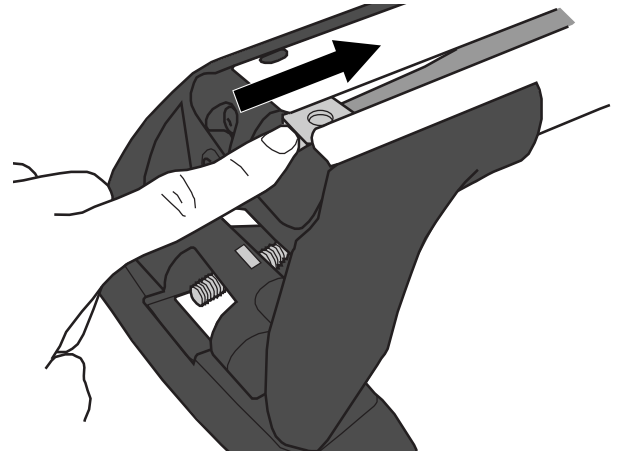

5

Repeat for all four positions.

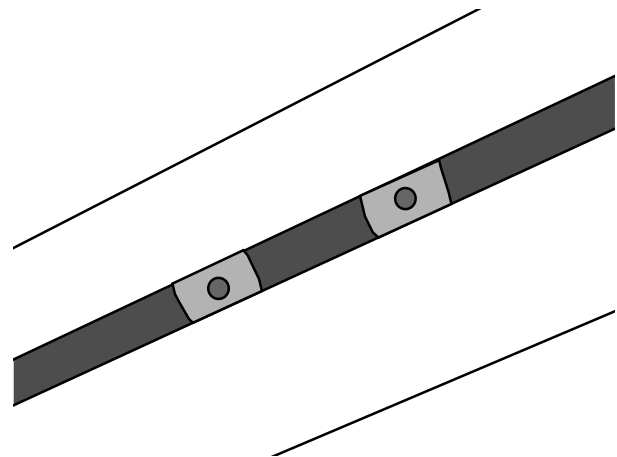

6

Position kayak stand over square nuts.

Attach kayak stand to square nuts using capscrews.
Tighten capscrews using Allen Key.

Repeat for both holders.

NOTE: Use shorter capscrews.

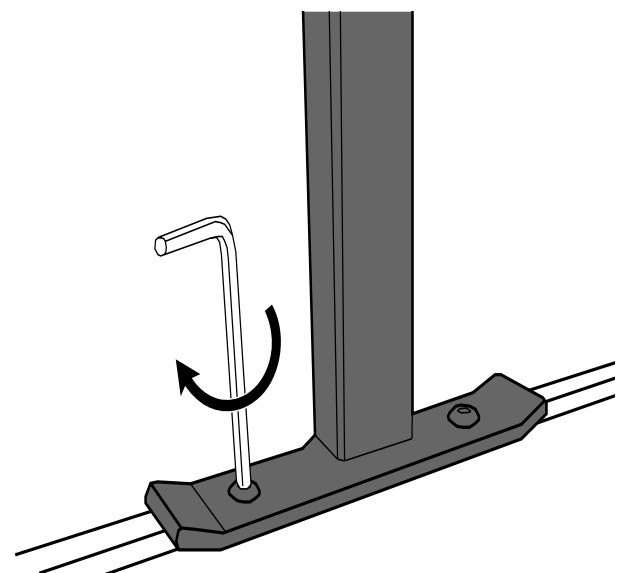

Installation for P-Bars

1 Place U-bolt over base of kayak stand, as shown.

Fit U-bolt plate.

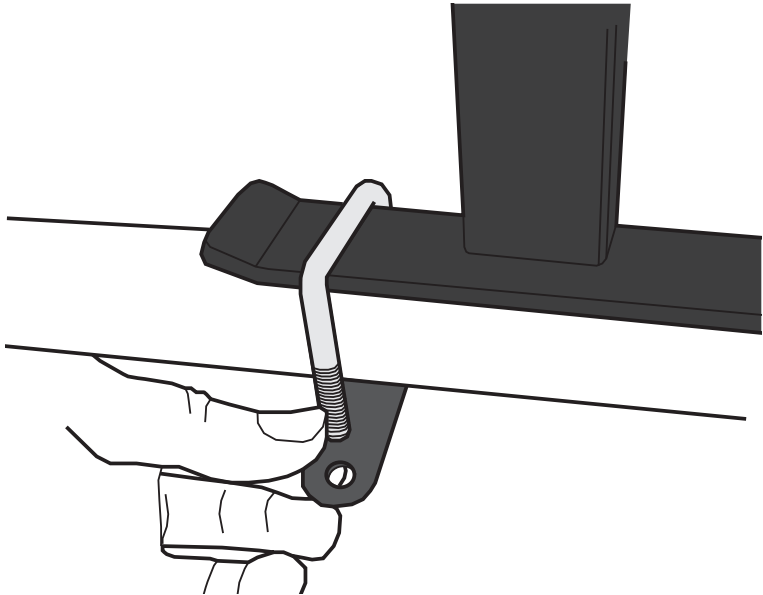

2 Secure evenly with knobs.

Repeat for both holders.

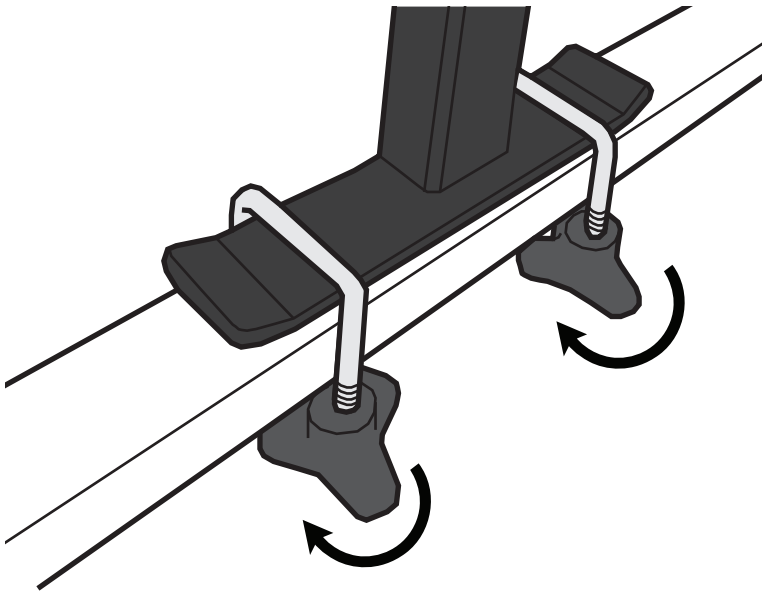

Installation for HD Bars

- 1 Place spring nut into crossbar channel.

Position where you want the accessory to be.

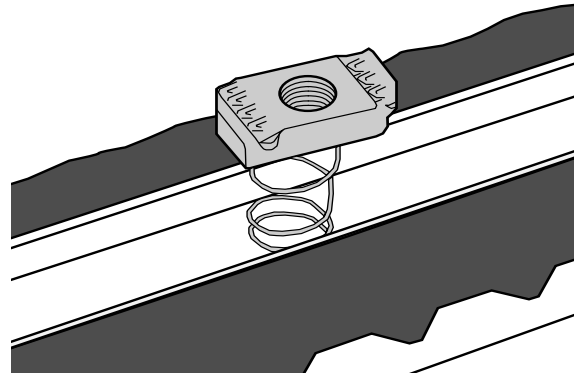

- 2 Push down and twist spring nut to lock into place.

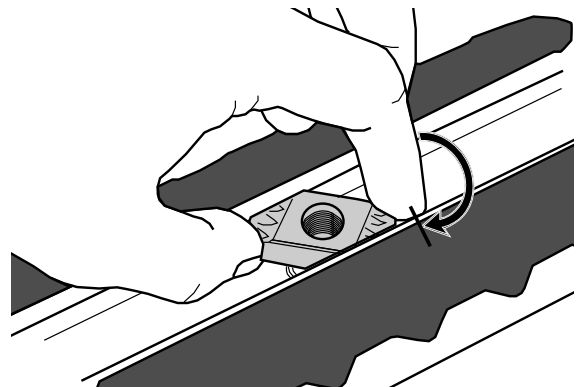

- 3 Repeat for all four positions.

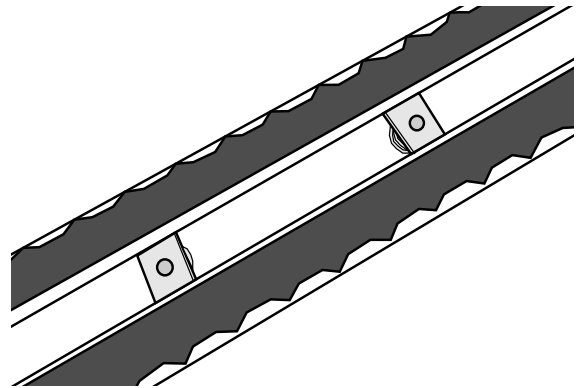

- 4 Position kayak stand over square nuts.

Attach kayak stand to square nuts using capscrews. Tighten capscrews using Allen key.

Repeat holders.

NOTE: Use longer capscrews.

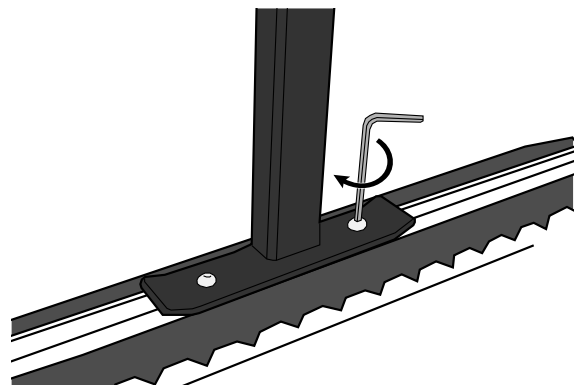

Installation for all Bars

- 1** Place sleeve over stand as shown.

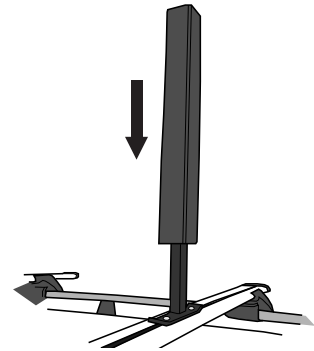

- 2** Thread tiedown through hoop at top of kayak stand.

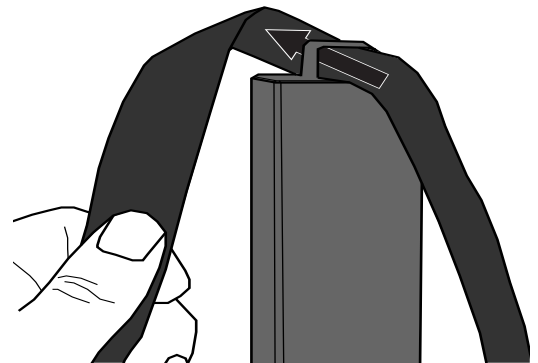

- 3** Place hull of kayak on bars, resting against stand upright.

Place both ends of the camlock strap over the front of the kayak.

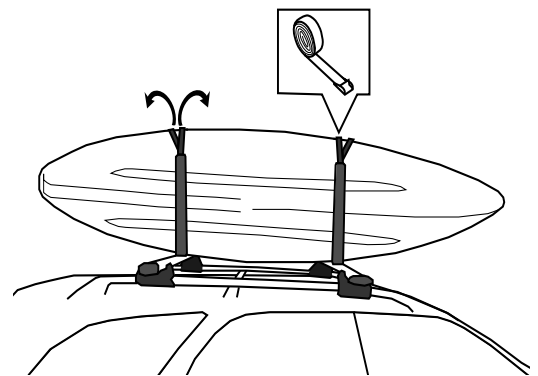

- 4** Put end of strap under crossbar and back up through camlock buckle. Pull down to tighten.

Repeat for both holders.



- 5** Long loads should be secured with non elastic straps to the front and rear of the vehicle.

A loaded roof rack system can alter the performance of your vehicle. Be especially aware of the effects of side winds, changing of direction, and braking performance. Avoid rapid acceleration and deceleration. Drive carefully.

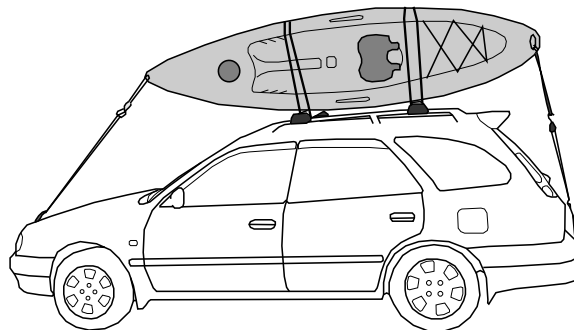

- 6** The purchase of an addition camlock set (PR3036) will enable a second kayak to be strapped to the kayak stand.

NOTE: Tie downs necessary to secure kayak front and rear, are sold separately.

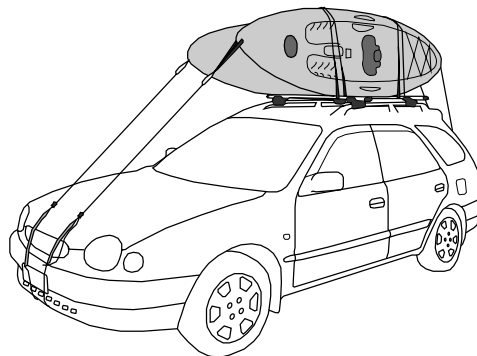

Safety Checks

- Before Driving Away:
 - Ensure all hardware is secured according to instructions.
 - Test movement by rocking boat.
 - Tighten again if loose.
- Attachment hardware can loosen over time:
 - Check straps periodically during travel and tighten if necessary.
 - Replace any straps that are worn or frayed before using (see your Prorack dealer).
- Some longer loads may prevent the rear hatch from fully opening.
Always use caution when opening your hatch.



Care and Maintenance

- Use non-water soluble lubricant on screws. Use a soft cloth with water and mild detergent to clean plastic parts.



Prorack
17 Hinkler Court, Brendale
QLD 4500, Australia

Freephone
AU: 1800 143 548
NZ: 0800 4776 722

www.prorack.com.au
www.prorack.co.nz

ALL CONTENT SUBJECT TO YAKIMA AUSTRALIA PTY LTD COPYRIGHT © 2017